

## Lynx-CustomFit® Splice-On Connector Ver. 2 - LYNX2-LC for 250um or 900um Tight Buffered Fiber - Installation Manual

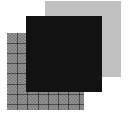

### For your safety operation

The Lynx-CustomFit® Splice-On Connector is designed and manufactured to assure personal safety. Improper operation can result in bodily injury and serious damage to this product. Please read and observe all warnings instructions given in this operation manual.

- ⚠ **Wear safety glasses** to protect your eyes when handling optical fiber.
- ⚠ **Never look into** the end of a microscope or optical cable connected to an optical output device that is operating. Laser radiation is invisible, and direct exposure can severely injure the human eye.
- ⚠ **Alcohol is flammable**, causes irritation and is harmful if swallowed or inhaled. Keep alcohol away from heat, sparks, skin, and avoid contact with eyes.
- ⚠ In the case of the work at the high place, please be careful not to drop an assembling tool.

### Composition

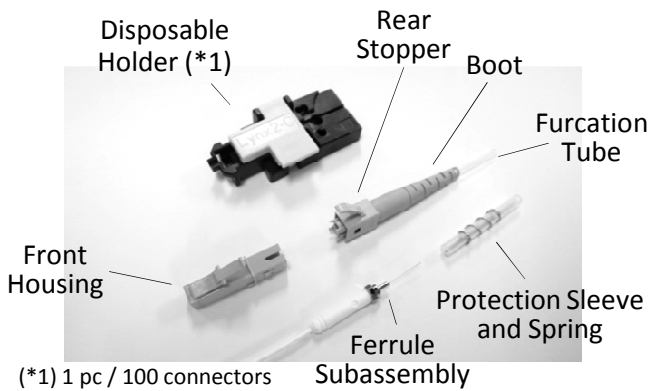

### Recommended Program

Splicer	Fiber	Splicing Program	Heater Program
T-Q101-CA (T-71)	SMF	SMF Standard	Lynx
	MMF	MMF Standard	
T-QH201e (T-201)	SMF	SMF Standard	Lynx
	MMF	MMF Standard	





SMF : G.652, G.657  
MMF : MM50(OM2), MM50(OM3), MM50(OM4), MM62.5(OM1)

### Precautions

- Improper assembly will result in a loss of performance. Please read instructions given in this operation manual and the operation manual of the fusion splicer.
- Never touch the fiber of the stub. It has been inspected in the factory.
- The product is sensitive to dirt or dust. Do not take out any parts from the package until it is to be used.
- The characteristic will be influenced by the fiber cleaved surface condition. Please use a cleaver which has a good cleaving characteristic.
- Do not remove the dust cap until the connector has been completely assembled in order not to cause an high insertion loss due to them.

### Assembling Tools

Either one holder is required.

Holder (Fiber Side)			
for 900um tight buffer		for 250um fiber	
LYNX2-UML-S	FHS-09	FHS-025	LYNX2-S-LB5
			

Below equipment or tool are examples.

Fusion Splicer T-Q101-CA, etc.	Fiber Cleaver FC-6S-C, etc.	Jacket remover JR-M03, etc.
		
Holder Type	Cleave length: 10mm	

- 💡 Please perform Arc test prior to the splicing operation. (See the operation manual of the splicer.)
- \*Fiber for testing is not included in the kit.
- 💡 Please check fiber type inside the field fiber.

**North Carolina (USA)**  
Sumitomo Electric Lightwave Corp.  
78 Alexander Drive, P.O. Box 13445, RTP, NC 27709  
TEL +1-919-541-8100  
<http://www.sumitomoelectric.com/>

**London (UK)**  
Sumitomo Electric Europe Ltd.  
220 Centennial Avenue, Elstree, Herts. WD6 3SL, UK  
TEL +44 (0)20-8953-8118  
<http://www.sumielectric.com/>

**Yokohama (Japan)**  
Sumitomo Electric Industries, Ltd.  
(Lightwave Network Products Division)  
1, Taya-cho, Sakae-ku, Yokohama 244-8588, Japan  
TEL +81-45- 853-7223, <http://global-sei.com/fttx/>

**(A) Set Fusion Condition**

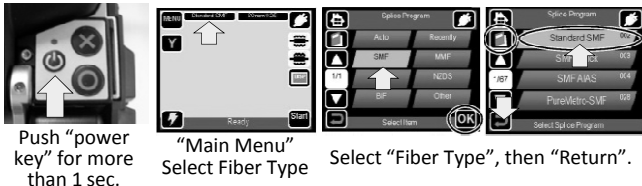

**(B) Perform Arc Test**

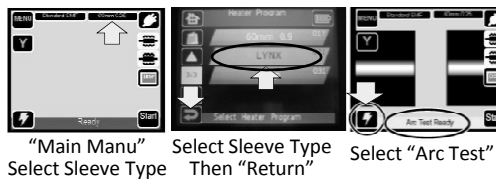

Then perform the arc test according to the instruction.  
\*Fiber for testing is not included in the kit.  
Please check fiber type inside the field fiber.

See the operation manual of each splicer. These are the example of T-Q101-CA (T-71C).

**(1) Slide Rear Parts onto the fiber.**

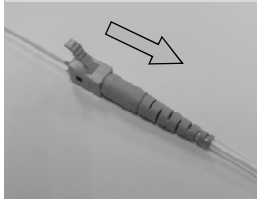

**(2) Slide Protection Sleeve onto the fiber.**

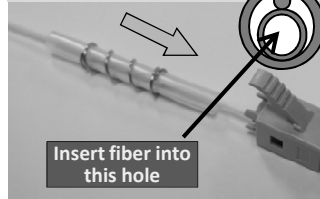

**(3) Remove the fiber coating. Approx. 35mm (JR-M03)**

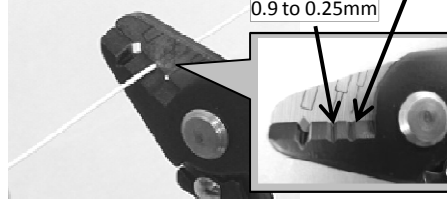

**(4) Clean the fiber with lint-free cleaning wipe.**



**(5) Set the fiber on the holder.**

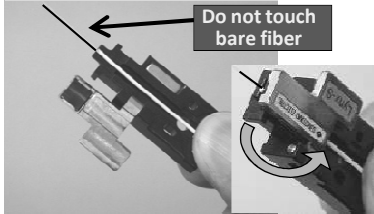

**Confirm the position**

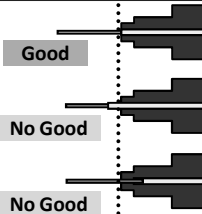

**(6) Cleave the fiber (FC-6S)**

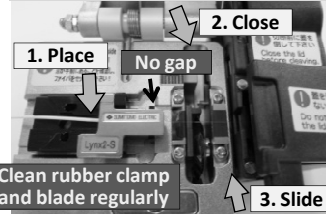

**(7) Set fiber holder on the splicer (left side).**



**(8) Pick up the stub and set the stub on the plastic holder.**

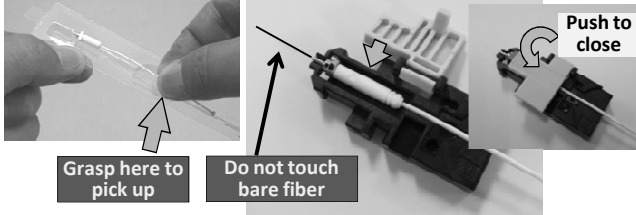

**(9) Set stub holder on the splicer (right side).**



**(10) Fusion Splice.**



**(11) Open the stub and fiber holders.**

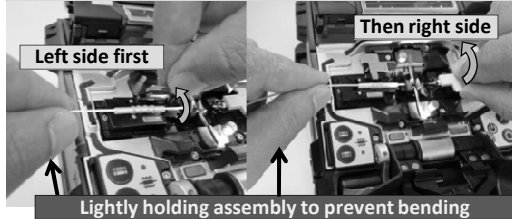

**(12) Pick up the spliced fiber.**

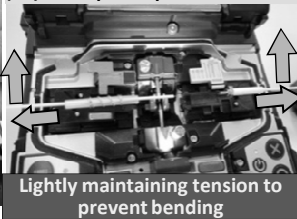

**(13) Slide Protection until it covers the projection of the flange.**

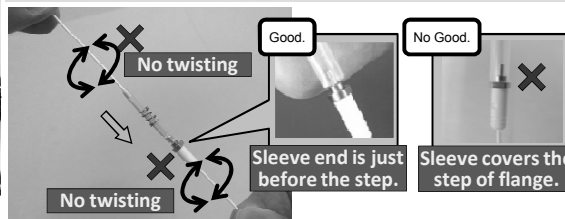

**(14) Set Sleeve into the heater.**

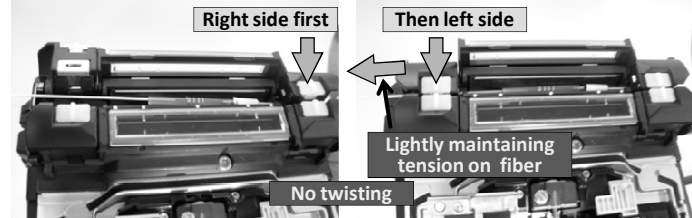

**(15) Confirm the position before heating.**

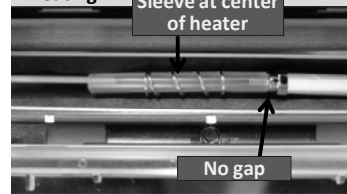

**(16) Heat Protection Sleeve.**

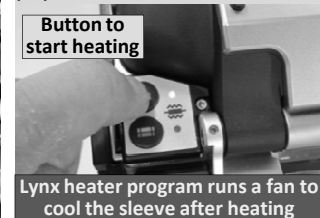

**(17) Pick up Sleeve.**

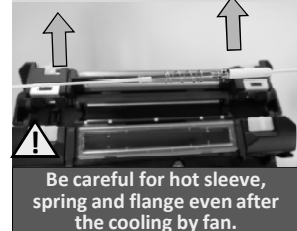

**(18) Key Alignment.**

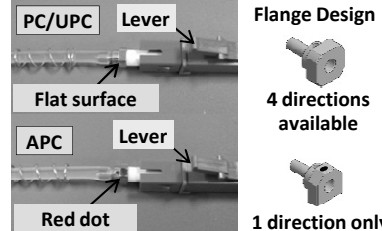

**(19) Put the front housing into the rear stopper.**

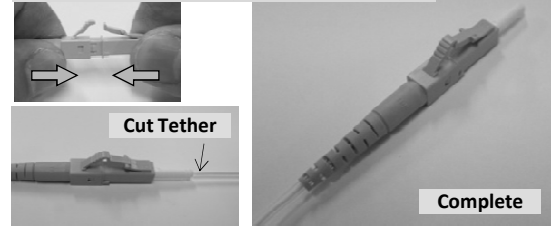

## - Attention of the installation manual-

**Legend** **Caution** Refer to this manual and operate to correctly.  
**Prohibition** False operation. Do not perform!

### Point ① Fiber installation process

#### Place the fiber

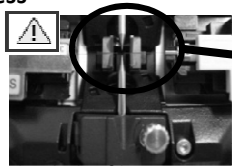

Check the fiber position on V-groove.

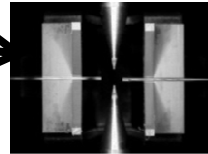

Fiber should be aligned along the V-groove

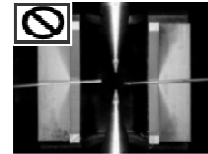

Do not place the out of V-groove or the fiber tends to break.

#### Close the cover

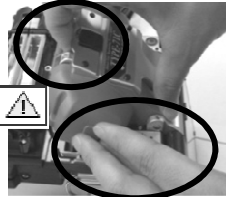

Hold the cover with both hands and close gently.

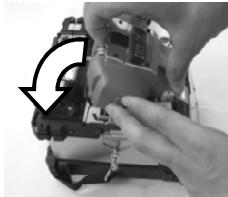

Do not stomp the cover or the fiber tends to broken



### Point ② Protection sleeve slide process

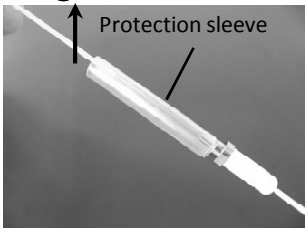

Protection sleeve

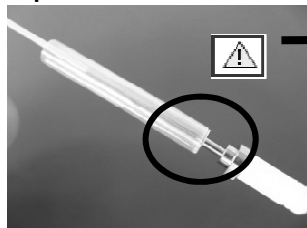

Raise the fiber end up so that the protection sleeve slides accordingly.

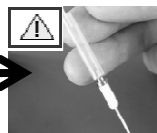

Do not shake!

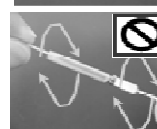
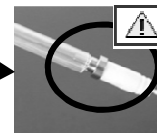

Pick the sleeve to adjust position.

In case protection sleeve sticks on the flange.

The fiber will **break** by stress.

Do not twist!

### Point ③ Protection sleeve set position

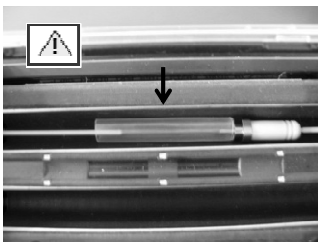

After heating.



**Good.** No bubble

If protection sleeve do not set at center.

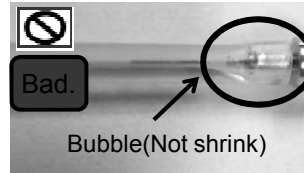

**Bad.** Bubble(Not shrink)

Refer to reverse side.

The fiber will **break** by stress.

Set the protection sleeve **at center of heater**.

### Point ④ Protection Sleeve's Shrink Condition

SC  
FC  
LC

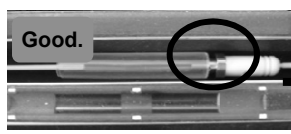

Flange's step is exposed



Flange's step is exposed

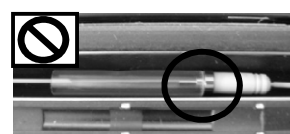

No gap to flange between sleeve.

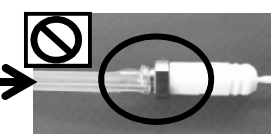

Glue is stuck to the flange

If Protection Sleeve have the bad condition. Please **retry** using the another new LYNX connector.