

Lynx-CustomFit® Splice-On Connector Ver. 2 - LYNX2-LC for 900um Loose Buffered Fiber - Installation Manual



For your safety operation

The Lynx-CustomFit® Splice-On Connector is designed and manufactured to assure personal safety. Improper operation can result in bodily injury and serious damage to this product. Please read and observe all warnings instructions given in this operation manual.

- Wear safety glasses** to protect your eyes when handling optical fiber.
- Never look into** the end of a microscope or optical cable connected to an optical output device that is operating. Laser radiation is invisible, and direct exposure can severely injure the human eye.
- Alcohol is flammable**, causes irritation and is harmful if swallowed or inhaled. Keep alcohol away from heat, sparks, skin, and avoid contact with eyes.
- In the case of the work at the high place, please be careful not to drop an assembling tool.

Precautions

1. Improper assembly will result in a loss of performance. **Please read instructions** given in this operation manual and the operation manual of the fusion splicer.
2. **Never touch the fiber of the stub**. It has been inspected in the factory.
3. The product is sensitive to dirt or dust. Do not take out any parts from the package **until it is to be used**.
4. The characteristic will be influenced by the fiber cleaved surface condition. Please use a cleaver which has a good cleaving characteristic.
5. Do not remove the dust cap **until the connector has been completely assembled** in order not to cause a high insertion loss due to them.

Composition

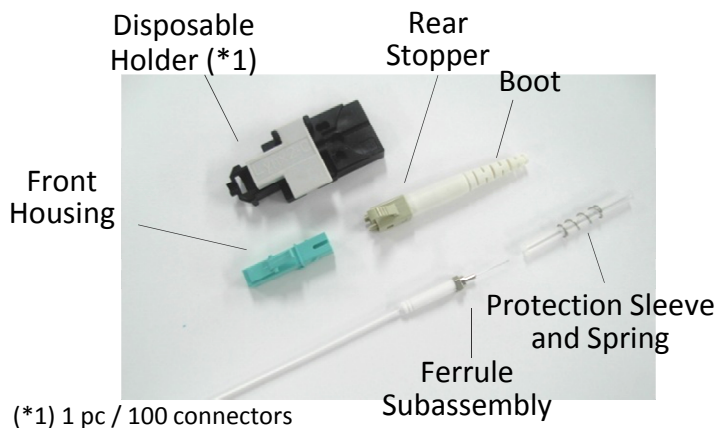

Assembling Tools

The below holder is required.



Below equipment or tool are examples.

Fusion Splicer T-Q101-CA(71C), etc.	Fiber Cleaver FC-6S-C, etc.	Jacket remover JR-M03, etc.
 Holder Type	 Cleave length: 10mm	

Recommended Program

Splicer	Fiber	Splicing Program	Heater Program
T-25eS	SMF	SM1: SMF1C	Lynx or FPS (60mm)
	MMF	MM1: MMF1C	
T-39FH	SMF	LYNX-SM	Lynx or FPS (60mm)
	MMF	LYNX-MM	
T-Q101-CA (T-71C)	SMF	Standard SMF	Lynx or 60mm 0.9
	MMF	MMF 50&62.5	

SMF : G.652, G.657
MMF : MM50(OM2), MM50(OM3), MM50(OM4), MM62.5(OM1)

- Please perform Arc test prior to the splicing operation. (See the operation manual of the splicer.)
- *Fiber for testing is not included in the kit.
- Please check fiber type inside the field fiber.

North Carolina (USA)
Sumitomo Electric Lightwave Corp.
78 Alexander Drive, P.O. Box 13445, RTP, NC 27709
TEL +1-919-541-8100
<http://www.sumitomoelectric.com/>

London (UK)
Sumitomo Electric Europe Ltd.
220 Centennial Avenue, Elstree, Herts. WD6 3SL, UK
TEL +44 (0)20-8953-8118
<http://www.sumielectric.com/>

Yokohama (Japan)
Sumitomo Electric Industries, Ltd.
(Lightwave Network Products Division)
1, Taya-cho, Sakae-ku, Yokohama 244-8588, Japan
TEL +81-45- 853-7223, <http://global-sei.com/fttx/>

(A) Set Fusion Condition



Push "power key" for more than 1 sec.



"Main Menu" Select Fiber Type



Select "Fiber Type", then "Return".

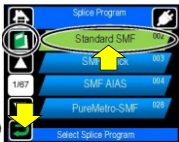

"Main Menu" Select Sleeve Type Then "Return"



Select "Arc Test"

(B) Perform Arc Test



Then perform the arc test according to the instruction.
*Fiber for testing is not included in the kit.
Please check fiber type inside the field fiber.

See the operation manual of each splicer. These are the example of T-Q101-CA (T-71C).

(1) Slide Rear Parts onto the fiber.



(2) Slide Protection Sleeve onto the fiber.

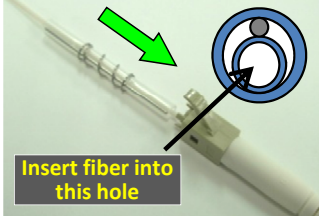

(3) Remove secondary coating. Approx. 40mm (JR-M03)



(4) Remove primary coating. Approx. 35mm (JR-M03)

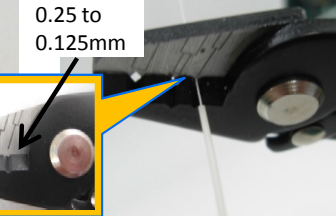

(5) Clean the fiber with lint-free cleaning wipe.



(6) Set the fiber on the holder.

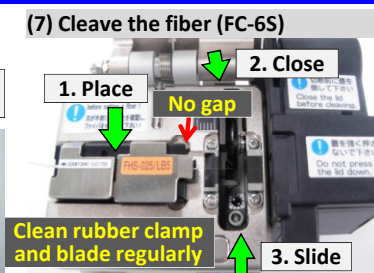
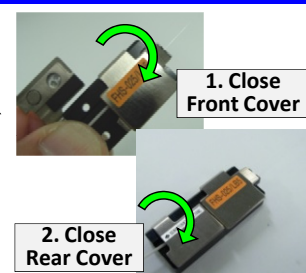
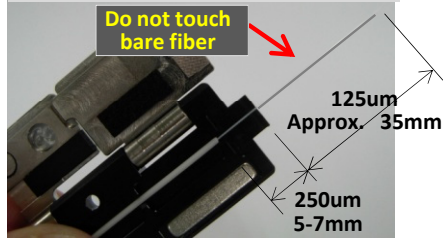

(9) Pick up the stub and set the stub on the plastic holder.

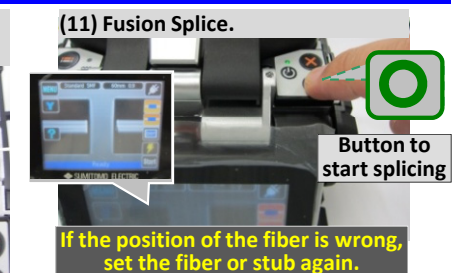
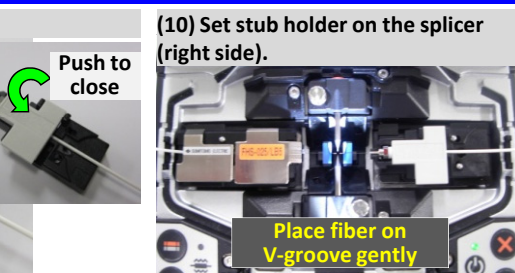
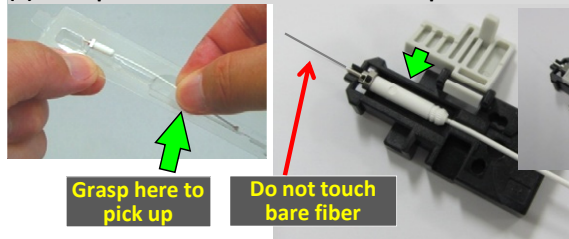

(12) Open the stub and fiber holders.

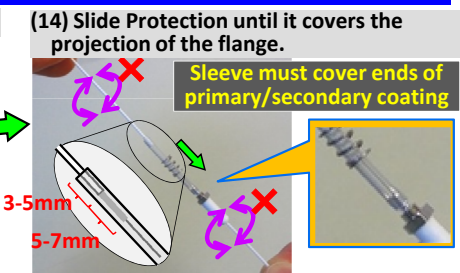
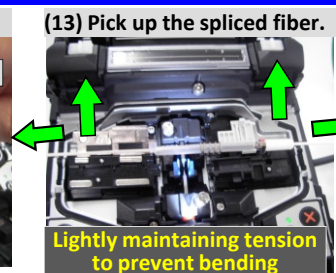
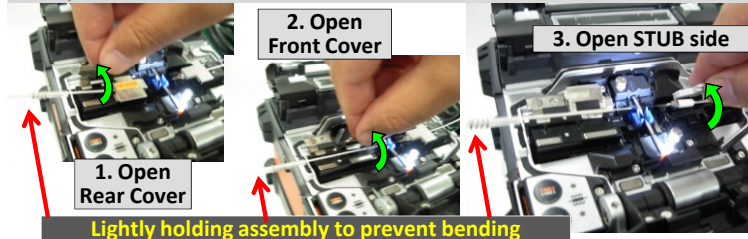

(15) Set Sleeve into the heater.

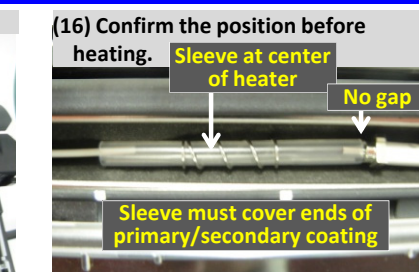
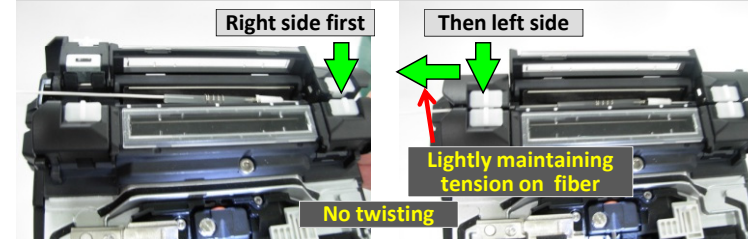

(18) Pick up Sleeve.

