

# Lynx-CustomFit® Splice-On Connector Ver. 2 - LYNX2-LC for 250um or 900um Tight Buffered Fiber - Installation Manual



## For your safety operation

The Lynx-CustomFit® Splice-On Connector is designed and manufactured to assure personal safety. Improper operation can result in bodily injury and serious damage to this product. Please read and observe all warnings instructions given in this operation manual.

- Wear safety glasses** to protect your eyes when handling optical fiber.
- Never look into** the end of a microscope or optical cable connected to an optical output device that is operating. Laser radiation is invisible, and direct exposure can severely injure the human eye.
- Alcohol is flammable**, causes irritation and is harmful if swallowed or inhaled. Keep alcohol away from heat, sparks, skin, and avoid contact with eyes.
- In the case of the work at the high place, please be careful not to drop an assembling tool.

## Precautions



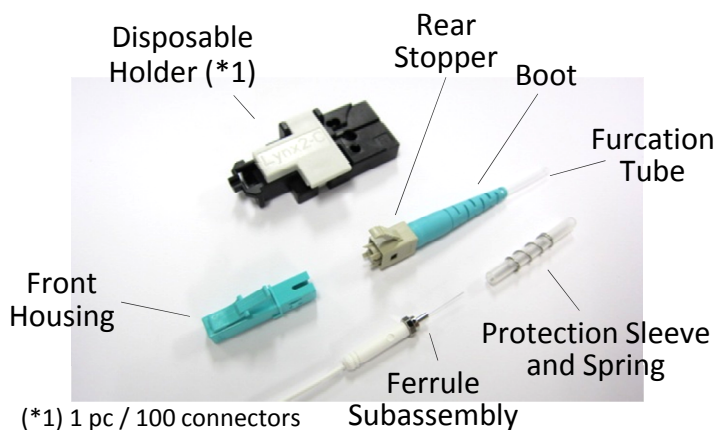

1. Improper assembly will result in a loss of performance. **Please read instructions** given in this operation manual and the operation manual of the fusion splicer.
2. **Never touch the fiber of the stub**. It has been inspected in the factory.
3. The product is sensitive to dirt or dust. Do not take out any parts from the package **until it is to be used**.
4. The characteristic will be influenced by the fiber cleaved surface condition. Please use a cleaver which has a good cleaving characteristic.
5. Do not remove the dust cap **until the connector has been completely assembled** in order not to cause a high insertion loss due to them.

## Composition



## Assembling Tools

Either one holder is required.

Holder (Fiber Side)			
for 900um tight buffer		for 250um fiber	
LYNX2-UML-S	FHS-09	FHS-025	LYNX2-S-LB5
			

Below equipment or tool are examples.

Fusion Splicer	Fiber Cleaver	Jacket remover
T-Q101-CA(71C), etc.	FC-6S-C, etc.	JR-M03, etc.
		
Holder Type	Cleave length: 10mm	

## Recommended Program

Splicer	Fiber	Splicing Program	Heater Program
T-25eS	SMF	SM1: SMF1C	Lynx or FPS (60mm)
	MMF	MM1: MMF1C	
T-39FH	SMF	LYNX-SM	Lynx or FPS (60mm)
	MMF	LYNX-MM	
T-Q101-CA (T-71C)	SMF	Standard SMF	Lynx or 60mm 0.9
	MMF	MMF 50&62.5	

SMF : G.652, G.657  
MMF : MM50(OM2), MM50(OM3), MM50(OM4), MM62.5(OM1)

- Please perform Arc test prior to the splicing operation. (See the operation manual of the splicer.)
- \*Fiber for testing is not included in the kit.
- Please check fiber type inside the field fiber.

**North Carolina (USA)**  
Sumitomo Electric Lightwave Corp.  
78 Alexander Drive, P.O. Box 13445, RTP, NC 27709  
TEL +1-919-541-8100  
<http://www.sumitomoelectric.com/>

**London (UK)**  
Sumitomo Electric Europe Ltd.  
220 Centennial Avenue, Elstree, Herts. WD6 3SL, UK  
TEL +44 (0)20-8953-8118  
<http://www.sumielectric.com/>

**Yokohama (Japan)**  
Sumitomo Electric Industries, Ltd.  
(Lightwave Network Products Division)  
1, Taya-cho, Sakae-ku, Yokohama 244-8588, Japan  
TEL +81-45- 853-7223, <http://global-sei.com/fttx/>

## (A) Set Fusion Condition



Push "power key" for more than 1 sec.



"Main Menu" Select Fiber Type



Select "Fiber Type", then "Return".

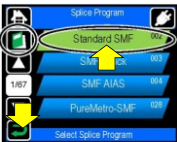

"Main Menu" Select Sleeve Type

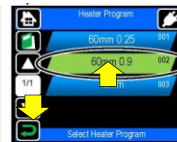

Select Sleeve Type Then "Return"

## (B) Perform Arc Test

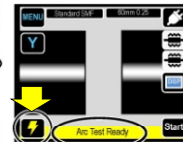

Select "Arc Test"

Then perform the arc test according to the instruction.  
\*Fiber for testing is not included in the kit.  
Please check fiber type inside the field fiber.

See the operation manual of each splicer. These are the example of T-Q101-CA (T-71C).

(1) Slide Rear Parts onto the fiber.

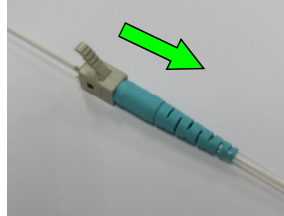

(2) Slide Protection Sleeve onto the fiber.

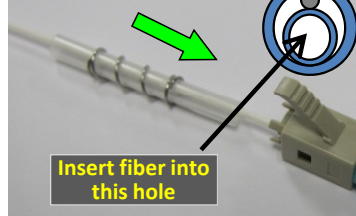

Insert fiber into this hole

(3) Remove the fiber coating. Approx. 35mm (JR-M03)



0.25 to 0.125mm

0.9 to 0.25mm

(4) Clean the fiber with lint-free cleaning wipe.



Moistened with alcohol

(5) Set the fiber on the holder.

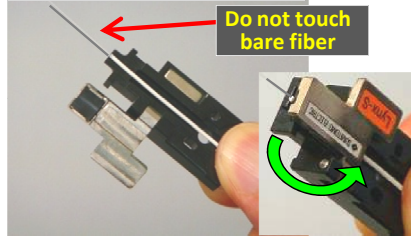

Do not touch bare fiber

Confirm the position

Good

No Good

No Good

(6) Cleave the fiber (FC-6S)

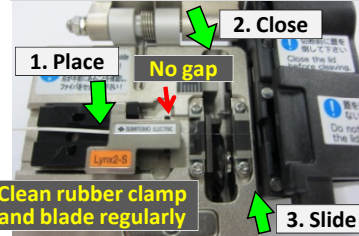

2. Close

1. Place

No gap

3. Slide

Clean rubber clamp and blade regularly

(7) Set fiber holder on the splicer (left side).



Place fiber on V-groove gently

(8) Pick up the stub and set the stub on the plastic holder.

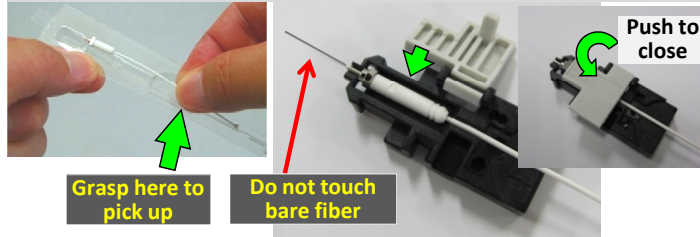

Grasp here to pick up

Do not touch bare fiber

Push to close

(9) Set stub holder on the splicer (right side).



Place fiber on V-groove gently

(10) Fusion Splice.



Button to start splicing

If the position of the fiber is wrong, set the fiber or stub again.

(11) Open the stub and fiber holders.

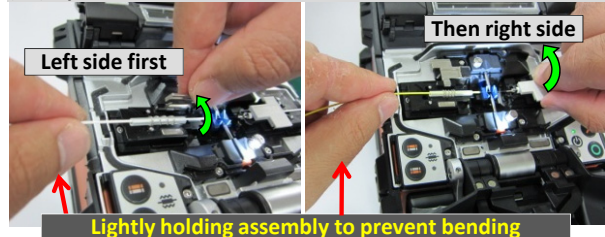

Left side first

Then right side

Lightly holding assembly to prevent bending

(12) Pick up the spliced fiber.

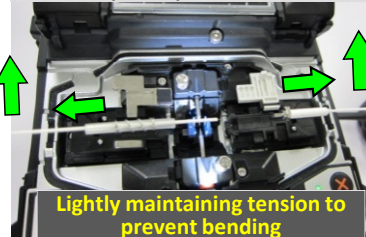

Lightly maintaining tension to prevent bending

(13) Slide Protection until it covers the projection of the flange.

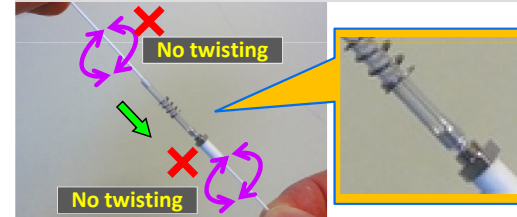

No twisting

No twisting

(14) Set Sleeve into the heater.

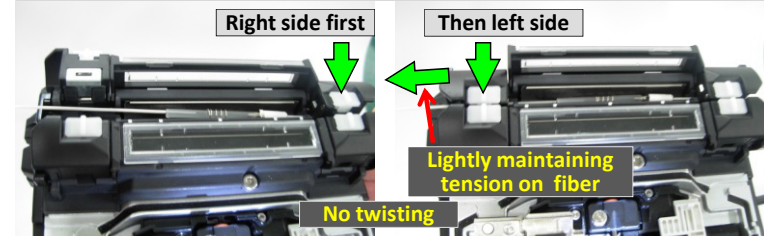

Right side first

Then left side

Lightly maintaining tension on fiber

No twisting

(15) Confirm the position before heating.

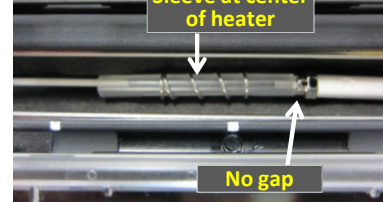

Sleeve at center of heater

No gap

(16) Heat Protection Sleeve.



Button to start heating

Lynx heater program runs a fan to cool the sleeve after heating

(17) Pick up Sleeve.



Be careful for hot sleeve, spring and flange even after the cooling by fan.

(18) Put Inner Housing.

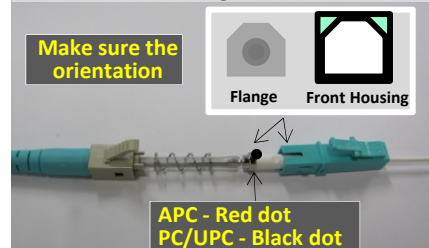

Make sure the orientation



Flange Front Housing

APC - Red dot  
PC/UPC - Black dot

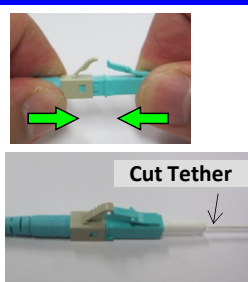

Cut Tether



Complete